

DREAMSCREEN

DREAMSCREEN

-Excelling your image-

Instruction Manual for
Motorized screen IR control with inner-setted and outer-setted

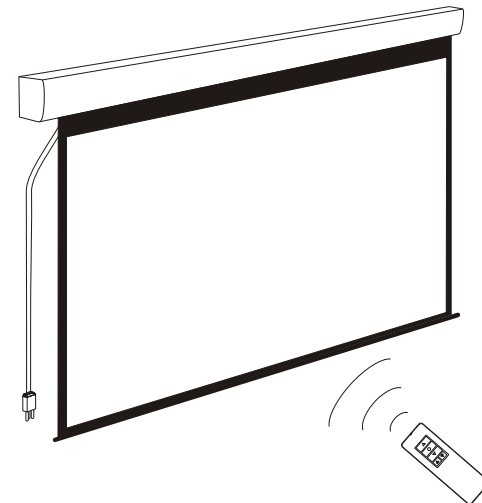

Thank you for purchasing a DreamScreen projection screen.
Before use, please read instructions carefully. After installation, store instructions for future reference.

Description

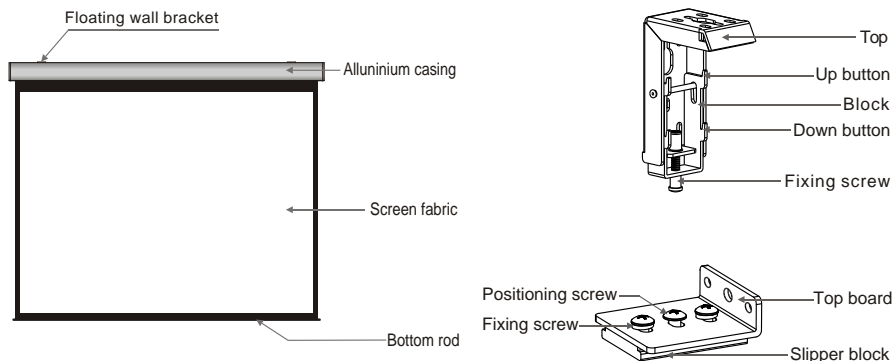

Accessories

- Floating wall bracket(2pcs)
- $\phi 5 \times 40$ mm Tapping screw & cap (8 sets)
- Top Board (2pcs)

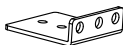
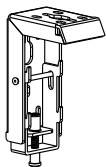

- M6x10 Screw (6pcs)



- Spring Washer (4pcs)



- Allen key (1pc)



- External IR Receiver (1pc)



- Instruction manual (1pc)

Motorized Screen Power Specifications

Voltage	Frequency	Watts	Application
230V/120V/100V	50Hz/60Hz	90W/80W	Applies up to 120" motorized screens

To avoid overheating the motor, do not continually retract and lower the screen for over 4 minutes at a time. If the motor overheats, it will need a cool down time of 2 minutes. The motor does not need any lubricants. The drop and retract limit of the screen is factory preset to an optimal configuration. Please ask your local dealer or professional to adjust settings to avoid damaging the motor.

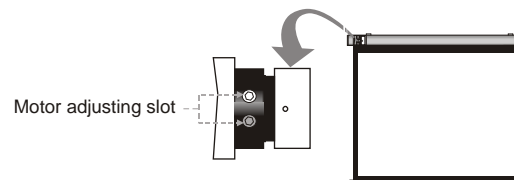

Warnings

- The ceiling or wall used for fixture installation must be secure to prevent the screens from falling.
- Make sure the Fixing screw be fastened when using the wall bracket, to avoid any damage. While installing electrical motors, please hire professionals or your local dealer to ensure safety. Amisconnection may lead to fire or leaks.
- Keep all infrared wireless products away from fluorescent lighting as it may cause malfunctions.
- Please read the following as any damage to the screen surface will affect the quality of the picture:
 - 1.Avoid contact or touching the screen surface as it may cause scratches or tears.
 - 2.Do not write or draw on the surface
 - 3.Clean the screen with a soft cloth and lukewarm water. Do not use any detergent or cleaning products.
- Roll up the screen after every use. Ensure that the screen is level when installing; do not pull on the sides or fold the screen.
- To prevent unnecessary damage, the operating and maintenance of the screen should be done by adults.



Ignoring the safety warnings may lead to injuries and/or damaging the product.



Fixtures should be installed in a secure place to avoid accidents or the screen falling.



Do not connect any electrical attachments or remote controls.



Roll up the screen after every use. Leaving it hanging for a long period of time may cause the fabric to loosen.



Please contact your local dealer for repairs or maintenance. Please contact our company if you have any further questions. Avoid taking apart the fixtures yourself. Loose parts may cause the screen to fall.



Refrain from hanging anything on the screen as it may cause the screen to fall.

Do not take apart and replace with unknown parts. If there are any problems, please contact your local dealer. Product specifications are subject to change.

Instructions

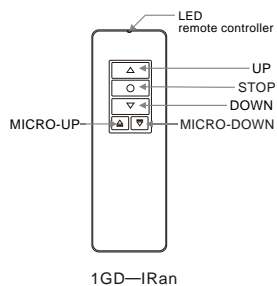

Controller button instruction

- 1.To raise screen press "UP".
- 2.To hold screen at desired position press "STOP".
- 3.To lower screen press "DOWN".
4. To raise the screen little at your desired position press "MICRO-UP"
5. To lower the screen little at your desired position press "MICRO-DOWN"

Caution:

- 1.The shortest distance between receiver and controller is 0.5 meter.
- 2.Controller will work within 30 degree away horizontally from the center of receiver point within 8 meters from the screen.
- 3.The controller will not work if the signal was covered by something.
- 4.Keep the controller far away from high temperature and humid situation.
- 5.Please change the battery when the signal is weak.
- 6.Please take the battery out if the controller was not being used for long time.
- 7.Please choose the same type battery as original supplied.

How to install the battery:

- 1.Turn the controller around, push to open the cover as guide arrow.
- 2.Put the battery in according the guide of cathode and anode.
- 3.Close the cover.

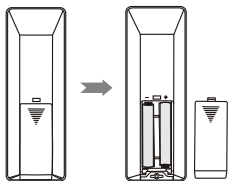

Spare outside receiver

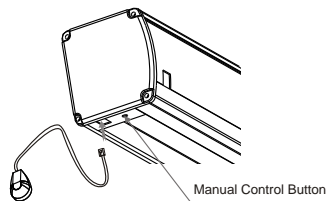

For hidden installation, plug the outside receiver in according to the drawing.

Manual Control Button

The button could control the screen manually and be effective repeatedly.

Installation

Take out all the parts from the packaging and follow the accessories guideline to ensure you have all parts.

There are three installation measures for this product, namely wall mounting, ceiling mounting and ceiling hang. The installed distance can be changeable up to your needs via adjusting the slipper block, while the ideal position is the mounting bracket is at its nearest point to the endcap, which can reduce unnecessary vibration or noise.

Floating wall bracket installation

1. Choose screws for mounting according to wall material. (Tips: Wood screws for wood wall, and Tapping screws for concrete wall.)
2. Mount the brackets onto the wall, assuring they are at the horizontal level. (Tips: draw an erasable level line when mounting the brackets) (Figure 1) Here below are the details:

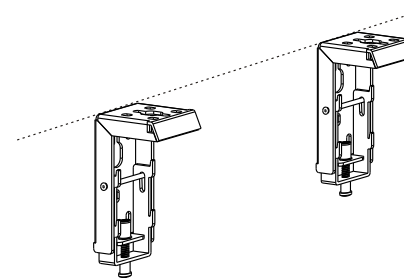

Figure 1

Installation Steps

- a) Wood wall and ceiling installation: Drill in the 5 x 60 screws through the appropriate holes in the bracket (Figure 2-3).
- b) Drywall and ceiling and installation: Install the anchors and drill in the 5 x 40 screws into the appropriate bracket holes. (Figure 4-5).

Wood wall installation

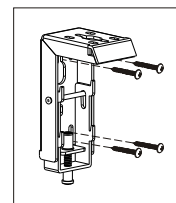

Figure 2

Wood ceiling installation

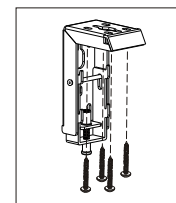

Figure 3

Concrete wall installation

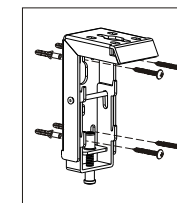

Figure 4

Concrete ceiling installation

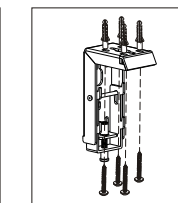
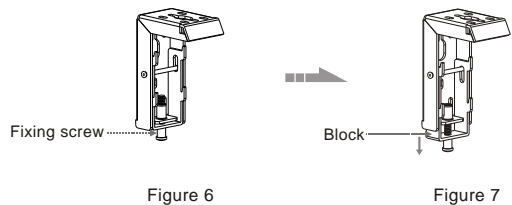
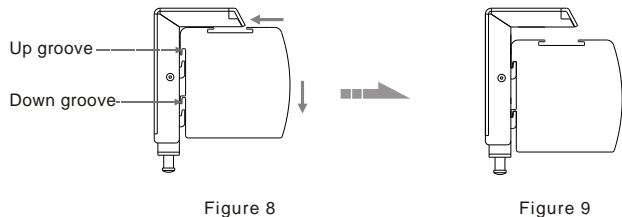

Figure 5

3. Loose the Fixing screw to lower down the Block all the way. (Figure 6-7)



4. When mounting the screen onto Floating wall brackets, make sure the Up groove and the Down groove on the housing match with the Up button and the Down button on the bracket separately. (Figure 8-9).



5. Fasten the Fixing screw on the bracket, to fix housing tightly onto the brackets. (Figure 10-11)

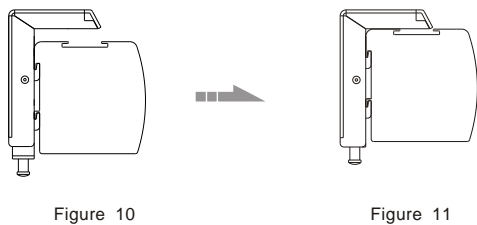

Floating hanging bracket installation

To choose the tapping screws with hanger or other screws with hanger (unprovided) according to ceiling material. (Tips: Wood screws $\phi 5 \times 60$ for wook ceiling and tapping screws for concrete wall.)

1. To drill two same holes with an electric drill horizontally with wall, then fasten hangers(unprovided) onto the ceiling. (Figure 12)

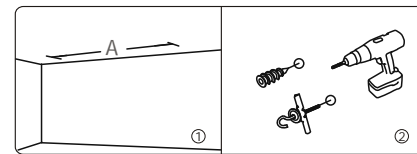

Figure 12

2. Use M6x10 Screws in the accessory package to fix the Top Boards on the Sliding Blocks which are on the groove on top of the screen, and make sure the Tightening Screws on both sides are fixed tightly, but temporarily not to fix tightly the Positioning Screws in the middle of Top Boards. (Note: please add washers in the Tightening Screws on both sides of Top Boards) (Figure13-14)

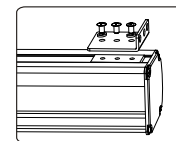

Figure 13

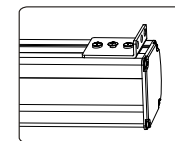

Figure 14

3. After hanging the casing onto pothook (Note: pothook shall be hung onto the middle holes of Top Boards), please check whether the casing is acclivitous, if it is, please unscrew the Tightening Screws and adjust the Top Boards to make the casing balanceable, and then fix tightly the Tightening Screws and Positioning Screws, to make sure the casing is fixed at suitable position (Figure15-16), and check the security of the pothook and make reasonable action to avoid any possibility of the Top Boards sliding down accidentally.

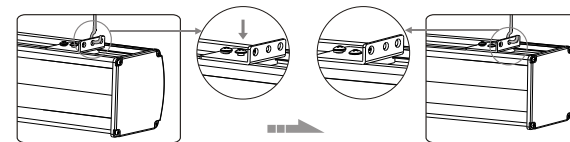

Figure 15

Figure 16